

ART. 241/50



Revolving door knobs in stamped aluminium sheet with a thickness of 0,12mm and an expansion square (mm.8) spindle in galvanised steel.

Anodized aluminium

▪ Finishes:

| | | | |
|---|--------------------------|------|----------|
|  | Polished gold | code | B |
|  | Satin gold | | F |
|  | Polished silver | | A |
|  | Satin silver | | E |
|  | Polished bronze | | C |
|  | Satin bronze | | G |
|  | Black electrocolour | | Z |
|  | Dark brown electrocolour | | I |

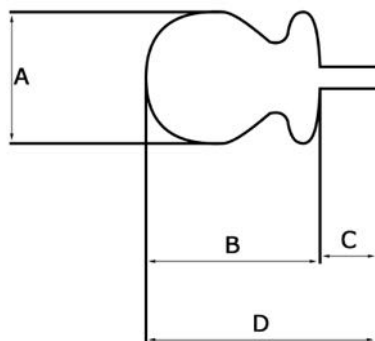

Expansion square spindle

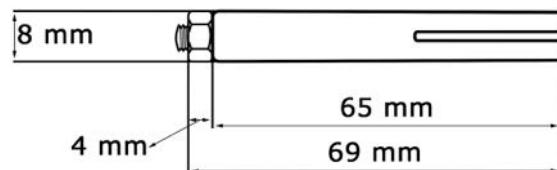

| ARTICLE | A | B | C | D |
|---------|----|----|-------------------|--------------------|
| 241/50 | 50 | 60 | min : 24 max : 47 | min : 84 max : 107 |

Measurements in mm.

Refer to the article 169/50 for the other specific measurement of the door knob.